

Swing Gate

SGR - 115

Bi-directional, logic controlled automatic swing gate with radar sensor.

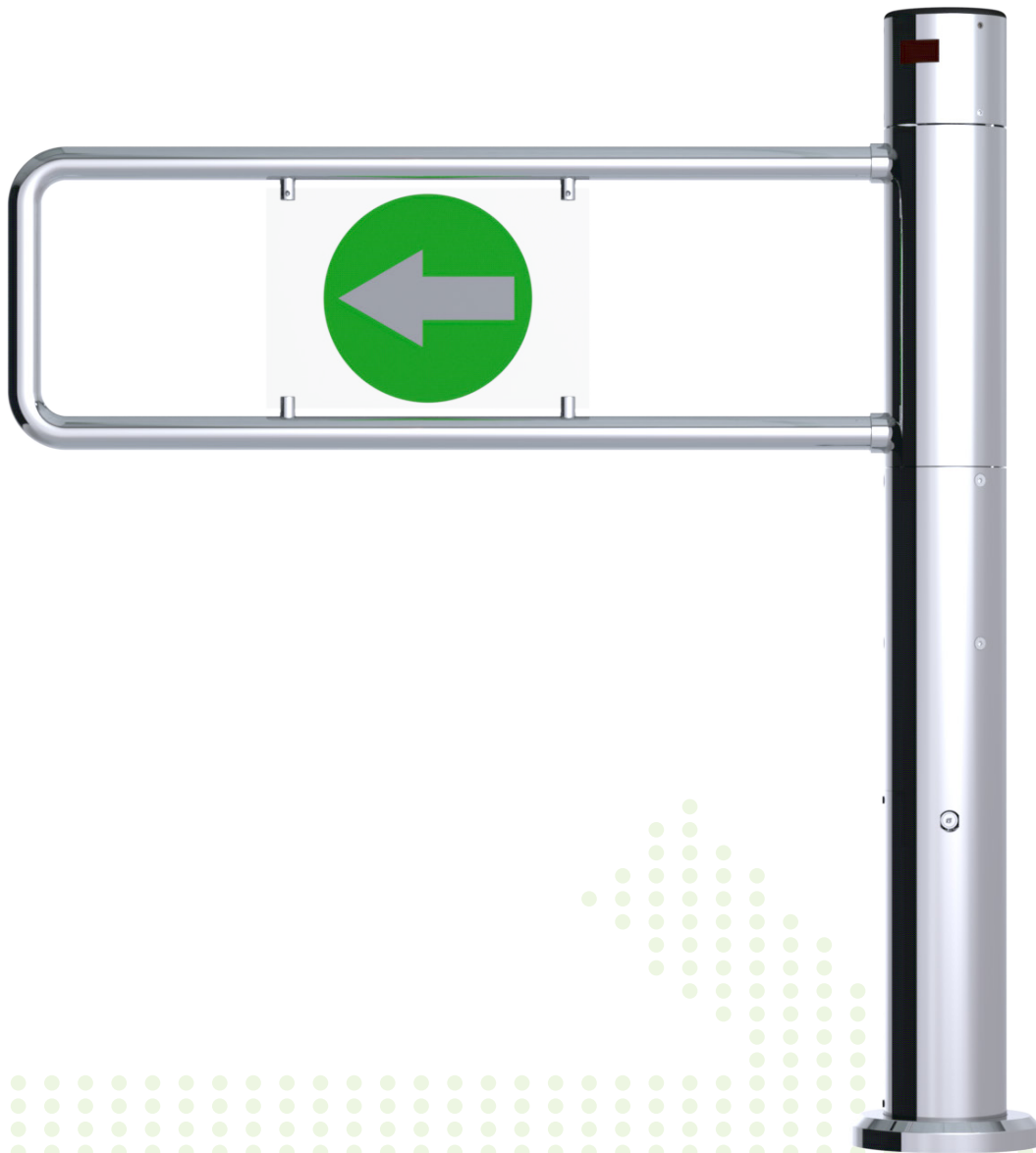

Swing Gate

SGR - 115

Materials

Stainless steel or powder coated steel housing. Barrier wing manufactured from stainless steel or aluminium tube with acrylic plate in the middle.

Drive Mechanism

Swing arm is opened by logic-controlled DC drive motor.

Functions & Interface

- Logic controlled interface, bi-directional operation
- Radar sensor for uni or bi-directional use.
- After the adjustable opening period has expired, the swing barrier wing closes the passage fully.
- Permanently open function.
- RS 232 serial port

Emergency & Power Cut

In the event of emergency the barrier wing opens in the determined direction and waits till the end of emergency before closing. During power-cut the mechanism unlocks the barrier wing and wing rotates freely in both directions.

LED Indicators (Optional)

LED lights indicates the operating status of the turnstile in both directions.

| | Option-1 | Option-2 |
|---------------|--------------------------|--------------------------|
| Green: | Standby or locked | Released or free passage |
| Red: | Released or free passage | Standby or locked |

Setting

| | |
|--------------------------------|-----------------------|
| Acoustic Notifications | : On / Off |
| Opening Period time out | : 5-10-15-20 secs |
| Consecutive passage | : On / Off |
| Emergency connection | : On / Off |
| Sensor controlled | : On / Off |
| LED Indicator options | : Option-1 / Option-2 |

Specifications

Construction: Staines Steel / Powder Coated Steel

Passage width: 900 mm

Barrier wing length: 800 mm

Opening-Closing Speed: 1,2 sec.

Cabinet diam.: 114 mm

Cabinet height: 1000 mm

Weight: 30 Kg

Power Supply: 100 - 240 VAC, 50/60 Hz

Logic Voltage: 24V DC

Standby power consumption: 9 W

Operation Temperature: -0 ° / +70 °

IP Protection: Cabinet IP44

Options & Accessories

- Remote control unit
- Stainless steel opposite post
- Photocell
- Logo engraving
- Posts for access control units
- LED Indicators

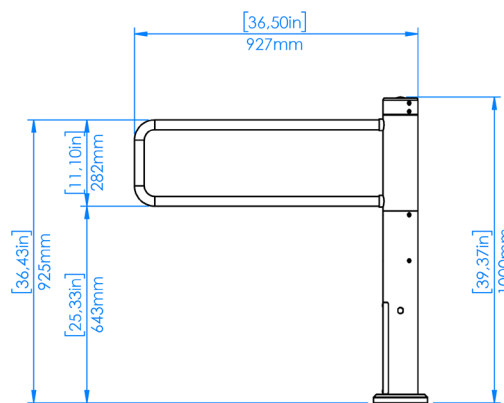

SCALE 1 : 20

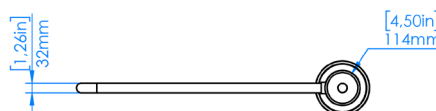

SCALE 1 : 20

